

MISSOURI SURVEYOR

A Quarterly Publication of the
Missouri Society of Professional Surveyors

Jefferson City, Missouri

June 2024

What's in this issue...

NSPS Student Competition.....	4
Community Outreach for Missouri Surveying	8
County Road Right of Way	10
MSPS Scholarship recipient Eli Hayes & Interactive Display About Surveying.....	12
NSPS News & Views.....	14
New Venue for Surveying Courses in Missouri.....	18
A Surveyors View of the Solar Eclipse.....	20
Official Report of a Guinness Record.....	22
Education for the Professional Surveyor	28
Surveyors Rendezvous.....	31
The Proposal to Modify the NCEES Model Law & Rules.....	34
Review Course.....	36
In Memory of Scotty Simer	39

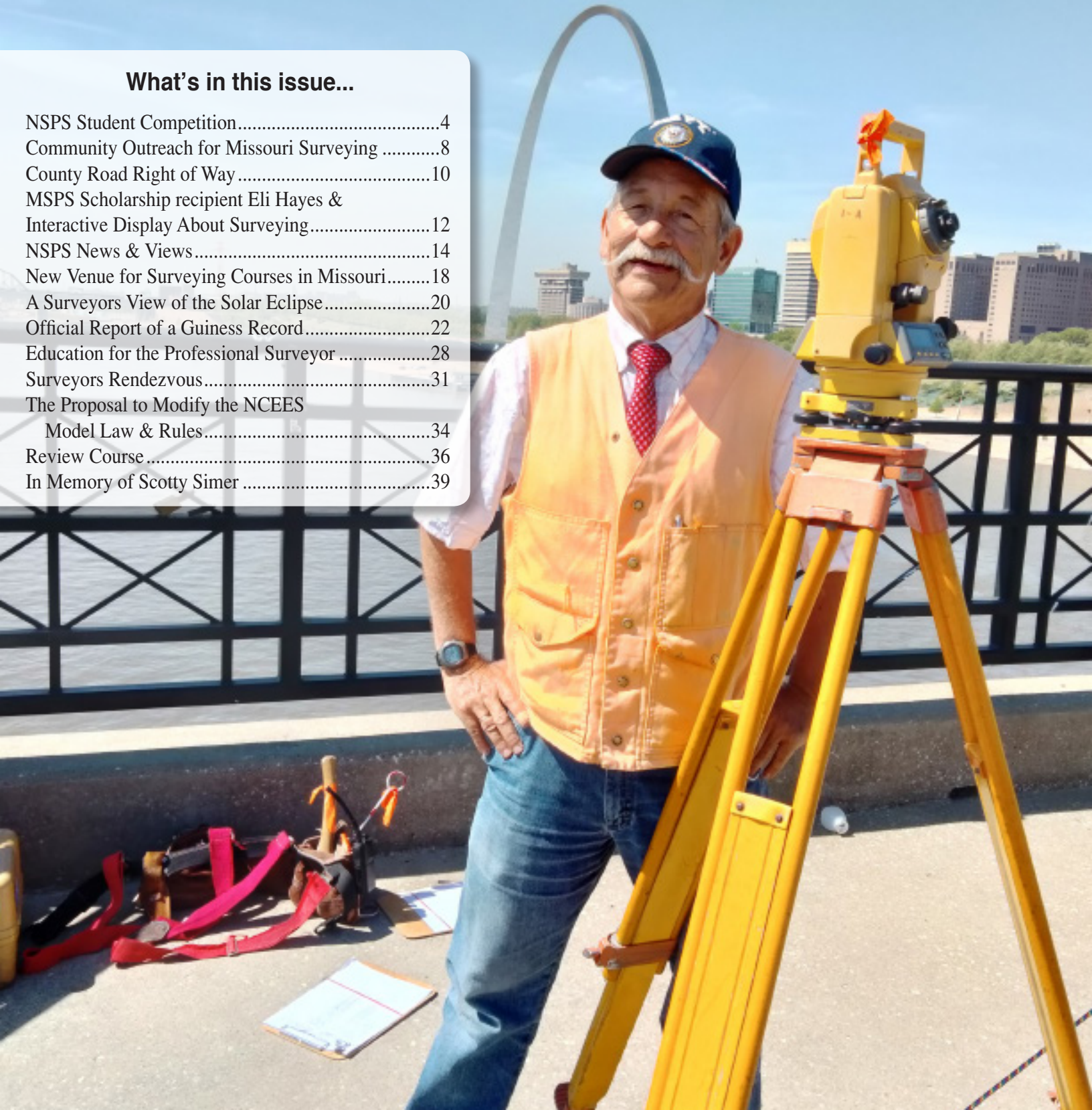

CALENDAR OF EVENTS

2024

July 10, 2024

Zoom Call, Board Meeting
MSPS Office, Jefferson City, MO

August 12-14, 2024

Review Course
Location TBD, Jefferson City, MO

October 3-5, 2024

67th Annual Meeting and Convention
Margaritaville Lake Resort
Osage Beach, MO

December 7, 2024

Zoom Call, Board Meeting
MSPS Office, Jefferson City, MO

May 1 & 2, 2025

Spring Workshop
Lodge of Four Seasons, Lake Ozark

October 2-4, 2025

Annual Meeting
Stoney Creek Inn, Independence

Front cover: PLS Ted Laneman on site for the measurement of the world record shoestrapping (see the article on Page 22).

Back cover: With Mr. Laneman, his survey party from T.L. Consultants of St. Louis; Judy Kittrell standing in front of Ted, and Emilio Rios on the left. In the back is Ms. Maria Cassilly of The City Museum.

Donald R. Martin, Editor



Notes from the Editor's Desk

Donald R. Martin



Okay, is it just me or is there anyone else exclaiming, “What is going on?” When it was a solar eclipse, it was kind of cool. Neat occurrence, overdone response by many. Then came the rains. Not the floods of 30 years ago, but smaller scale flash floods and soggy fields – another fine mess. And tornados! Yes, it is that time of year, and Missouri is alley adjacent, but come on! Northern lights this far south? Meteor showers! The Missouri legislative session! What more can we expect? What more can we take?

The answer is...CICADAS! The exoskeleton shedding sirens of soothing summer sounds for sleeping are on steroids this season! It is all approaching the unbearable... this has to be *it*. To be *all*. No more. Wait, what? There’s a presidential election on the horizon? Argh!

Oh well, at least we can count on the summer edition of *Missouri Surveyor*.

Hey, it’s a fun edition with a lot to share about the goings on of Missouri surveyors. Just take a look in our pages!

This issue starts off with the best kind of article; one written by a member. In this case it is Sarah Lovelady with *NSPS 23rd Annual Student Competition*. Thank you for this contribution to our pages Sarah. Pictures tell the story next as we see Ray Riggs sharing the news of surveyors and MSPS in *Community Outreach for Missouri Surveying*. The following article has an interesting background. Patrick Kliethermes of Linn is not a surveyor. But he has mastered research and among others, he has done research for surveyors. Along the way, he has developed an expertise in matters associated with retracing the records of county roads. See what he has to say in *County Road Right of Ways*. After that we have a picture to go with the name in *MSPS Scholarship Recipient Eli Hayes* and a peek at the *Interactive Display About Surveying* from Matt Thomas. Look for some of our colleagues in the next feature, *NSPS News & Views*. After that, we have news about Joe Paiva and a *New Venue for Surveying Courses in Missouri*.

We have a centerfold of sorts for this edition in the mid-pages with more photos from Matt Thomas in *A Surveyors View of the Solare Eclipse*. Those pics are followed by a unique report. From the historic Eads Bridge, in the shadow of the Gateway Arch we have the *Official Report of a Guinness Record* from Ted Laneman of St. Louis. After that we have Dave Sherill’s report on *Education for the Professional Surveyor*. Pamphlet contents follow from the Surveyors Historical Society with info about the *Surveyors Rendezvous 2024*. Then NSPS Immediate Past-President Bob Akins reports on *The Proposal to Modify the NCEES Model Law and Rules*. With that, I’ve about covered it.

Well, I best break-it-down and bunch-it-up so I can start getting ready for the next edition ...I’ll get back with ya’ then... 🇲🇴

Donald

THE MISSOURI SURVEYOR

Published quarterly by the
Missouri Society of
Professional Surveyors

OFFICERS

Bob Anderson President
Charles E. Quinby President-Elect
Mark Wiley Vice President
Chris Ferguson Secretary-Treasurer
Sandra C. Boeckman Executive Director
Ray Riggs Past President
Michael D. Zahner NSPS Director

DIRECTORS

Scott Faenger
Matt Thomas
Bart Korman
Phil Grout
Kellan Gregory
Austin DeSain

ADVERTISING RATES

	4 issues	1 issue
Full Page	650.00	200.00
Half Page (horizontal or vertical)	400.00	150.00
Quarter Page	250.00	100.00
Professional Card	50.00	N/A

COPY DEADLINE

March Issue — February 1
June Issue — May 1
September Issue — August 1
December Issue — November 1

EDITOR

Donald R. Martin
105 S. Capistrano
Jefferson city, MO 65109
Phone (573) 619-8702
E-mail: editor@missourisurveyor.org

PUBLISHER

Sandra Boeckman
722 E. Capitol Avenue
Jefferson City, MO 65101
(573) 635-9446 FAX (573) 635-7823
E-mail: msps@missourisurveyor.org

The Missouri Surveyor is published quarterly by the Missouri Society of Professional Surveyors, to inform land surveyors and related professions, government officials, educational institutions, contractors, suppliers and associated businesses and industries about land surveying affairs. Articles or opinions appearing in this publication do not necessarily reflect the viewpoints of MSPS but are published as a service to its members, the general public and for the betterment of the surveying profession. No responsibility is assumed for errors, misquotes or deletions as to its contents. Articles may be reprinted with due credit given.

President's Message

Bob Anderson, PLS



Another Spring Workshop is in the books. I would first like to express my gratitude to Kristopher Kline, who was very gracious with his time to give all of the presentations for the workshop. I also would like to thank the education committee, the vendors, and of course Sandy for making everything flow smoothly. We have had such great organization for so long that it is easy to take for granted how chaotic and difficult it is to plan such events and I really appreciate the efforts of all involved. The presentations were very interesting and informative, and there were many good questions and discourse from the audience.

Speaking of great organization, Judy Kempker, the executive director of the board for architects, professional engineers, professional land surveyors, and professional landscape architects, is retiring. The board held a ceremony for her at their meeting in St. Louis. Chuck Quinby was able to attend on our board's behalf and present her with a card and gift to thank her for her years of dedication. On all accounts, Judy did an excellent job for the board. She has always made herself available to help when needed. She also had to put up with the rowdy group of surveyors we sent her way. If for no other reason than that, she deserves the best and we wish her well in retirement.

Our NSPS Director, Mike Zahner, attended the Day on the Hill in Washington D.C. along with our board director and young surveyors committee chair, Kellan Gregory. They had the opportunity to meet with a few congressmen to discuss issues of interest to our profession and participate in judging for the student competition. As much as some of us malign politicians, and rightfully so, these events are useful in informing our representatives on issues that affect us and our clients that are probably under the radar for them with all the major and not so major issues they deal with every day. Phone calls, emails, and letters are great. But meeting face to face is usually more impactful.

In other news, the Missouri Department of Agriculture has given their approval to rename the Land Survey Program building in honor of Bob Meyers and a plaque is in the works to be mounted on the building. Jess Moss with the Land Survey Program is continuing to work on the distortion maps and a user's manual for the new state plane coordinate system set to be implemented in 2025. The Land Survey Program is also working with the Standards Committee to update the Missouri statutes in regard to the new system.

Lastly, I want to mention the change in the landscape of education for surveyors in Missouri. Educational opportunity in Missouri has been a challenge we've been tackling for several years. Joe Paiva is launching an exciting new venture to provide the education necessary for licensing that will be crafted to the needs of surveyors. He has an article in this newsletter that will provide more details. Please read his article and decide if this opportunity is suitable for any of the young surveyors in your life who desire to obtain their professional license. 🇺🇸

Until next time,
Bob Anderson

NSPS Student Competition

NSPS 23rd Annual Student Competition

Students, myself included, gathered in Washington DC to participate in this year's National Society of Professional Surveyors (NSPS) student competition. The NSPS teamed up with the Young Surveyors Network (YSN) to put on a monumental opportunity.

My name is Sarah Lovelady with Allgeier, Matin & Associates in Joplin, Missouri, and I am an associate/student member of MSPS, as well as an Associate member of the Southwest Chapter of MSPS. I am a student with Oklahoma State University – OKC acquiring my associate of applied science for Surveying Technology. This program will allow me to pursue licensure in Missouri, Oklahoma, and (for the future) Kansas and Arkansas.



Washington Monument



TEAM OSU-OKC PICTURED (from left to right) Jeff Sauer (Texas), Richard Kennedy (Texas), Caleb Robertson (Oklahoma), Sarah Lovelady (Missouri/Oklahoma)

We were charged with two days of various exercises that challenged our roots of knowledge in land surveying. Basic tasks included triangulation, traversing a four-sided tract, running a level loop and a 6-hour monument scavenger hunt. While the assignments themselves seem easy enough, students were not supplied with the latest and greatest technology that most of us “young bucks” are used to working with.

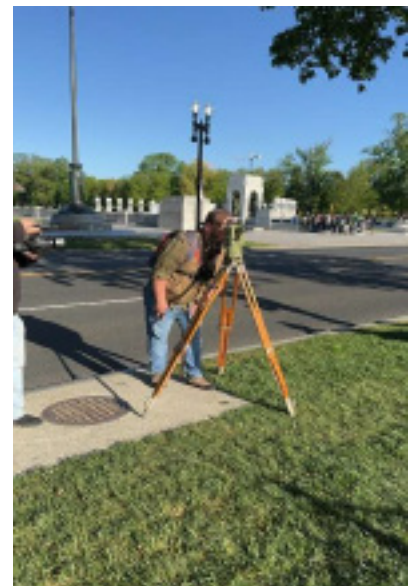

Jeff Sauer looks through a WILD T-2 Theodolite toward the Washington Monument



Sarah Lovelady peers through a WILD T-2 Theodolite, accompanied by teammates Caleb Robertson (left) and Richard Kennedy (right)

Our stops at the triangulation stations posed us with the first challenge of the day. I had never looked through a T-2 Theodolite before, nor did I know how to make the adjustments necessary for a proper reading. Thankfully, we had great lighting from the sun to view the vernier scale. Although, this was not the case at station two where the T-2 was set up in the shade. I personally struggled to read the angle. During calculations, it gave us a good perspective on the importance of proper and effective use of the equipment.



Richard Kennedy making compass adjustments

The final challenge on day one is where we were most successful. We ran a level loop with a dumpy level on stiff legs. Closing within one-hundredth, and completed this timed event in half the time that was allotted. Most of our team have experience in running level loops.



Jeff Sauer holds a Philadelphia rod



Sarah Lovelady takes a reading with a Dumpy level

(continued on next page)

Surveyors Materials, Inc.
 8875 Frost Avenue
 St. Louis, MO 63134
 Voice: 314-521-9041
 Fax: 314-521-9043
Edward Owen
 Vice President



FAX 573-483-2777 Ph. 573-483-2777
 Cell 573-883-6239

BADER LAND SURVEYING, INC.
GERALD BADER
 Missouri P.L.S.

16255 Sugar Bottom Rd. Sta. Genevieve, MO 63670

NSPS Student Competition *(continued)*

I've gained an appreciation for the history of land surveying. Technological advances have allowed for quick and efficient surveys. Surveyors can cover more ground in a lesser amount of time and hopefully see the profits from it. I can't imagine the frustrations that came with all that could go wrong in surveying and having to back track to find the bust.

The cherry on top of the competition was the monument scavenger hunt. We traveled to locations that I may never see again in my lifetime. We appreciated the hard work performed by

those who I could not tell you their name.

I've always respected surveyor's senior to me. The knowledge a young surveyor can gain from working alongside a 30 plus year experienced man is invaluable. We must take the time to watch and listen. We must continue to struggle through the countless challenges, even when we look a little foolish attempting to read a vernier scale. It's important. I am grateful for the experience provided by the NSPS and YSN.



Caleb Robertson (left), Sarah Lovelady (center), and Richard Kennedy (right) work on calculations in front of the Washington Monument



Washington DC East Corner (1792) Maryland face showing



Pictured (from left to right) Jeff Sauer (Texas), Sarah Lovelady (Missouri/Oklahoma), Richard Reed (NSPS – New York), Ryan Hightower (OSU-OKC Professor), Caleb Robertson (Oklahoma), Richard Kennedy (Texas)



Missouri
 3433 Tree Court Ind. Blvd.
 St. Louis, MO 63122
 Office: 314-968-2282

Kansas
 11801 W. 86th Terrace
 Lenexa, KS 66214
 Office: 816-331-3383

Tech Support: 844-266-7266



Want to try before you buy?
 Ask about our **TAKE FIVE** Rental Program

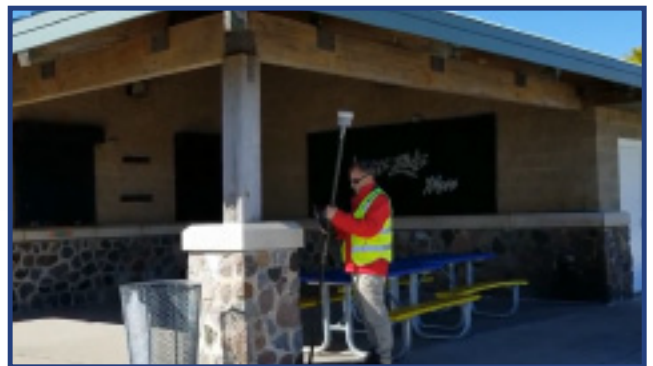

Providing high accuracy products, superior training and support since 1945

- Total station & GNSS solutions to exceed your productivity needs
- Field and office software that supports your workflows
- Scanning and leading aerial mapping solutions
- Training customized for the way you work
- Experienced and knowledgeable staff
- Service, repair, and rental solutions



SCAN ME



Sales • Service • Support • Rentals • Training • Consulting

Community Outreach for Missouri Surveying

by Ray Riggs, PLS



MSPS member Ray Riggs, PLS, flying the flag for Missouri surveying and our association! The event was the 32nd Annual Home & Garden Show of the Southern Missouri Builder's Association, open to the public on March 1st and 2nd at the West Plains Civic Center.



ZAHNER

AND ASSOCIATES, INC
PROFESSIONAL LAND SURVEYORS

DRIVING RESULTS

your partners in
**MOBILE LIDAR &
TERRESTRIAL SCANNING**



Learn more about how Zahner & Associates can help you provide your clients with safer, faster, more accurate data than ever before.

200 Zahner Place
Perryville, Missouri
573-547-1771
info@zahnerinc.com

Visit our website: www.zahnerinc.com

County Road Right of Way

by Patrick Kliethermes

Are you having issues with research concerning county roads and their rights-of-way?

In the late 1800's and early 1900's, before the establishment of county road systems, creation of public byways were local matters addressed within counties. When landowners in a vicinity needed a road for going to church, engaging in business, transporting goods and crops, they would turn to their county government. They could petition the county for a public road. If the County Court (now known as the County Commission) approved the establishment of such a road they would use processes outlined in law. The actions commenced with the participating landowners along the proposed route conveying in trust a right-of-way. In most instances, a conveyance of right-of-way deed was signed by the landowners and given to the County Court (Commission) and filed in the County Clerk's office. Many of these deeds were never recorded in the County Recorder of Deeds office. Some counties did, however, keep a "road right of way" or a "road conveyance" book that they kept of record in the County Clerk's office. Most surveyors and attorneys are taught to look in the Recorder's office for right-of-way conveyances, thinking all conveyances are recorded in the Recorder's office. Many in fact are not!

Even with the issue of a vacation of right-of-way, some of the ordinances and court orders are not recorded in the Recorder of Deeds office. They are however on file at the municipality or County Clerk's office. The right-of-way conveyance that was given to the county court was a conveyance in trust and if it did not go through a formal vacation per state statute RSMO 228.110 it still exists as a public right-of-way. Even if the physical road is there and the County does not maintain it, if the right of way was conveyed in trust and not vacated, it is still considered to be a public road.

Also, some private roads were petitioned to the County Court as well. If a property owner in the past was land locked and did not have access to the public road, they could petition the County Court to gain access to the public road. Again, they would have to go through the dedication process and get a court order through the County Court (Commission).

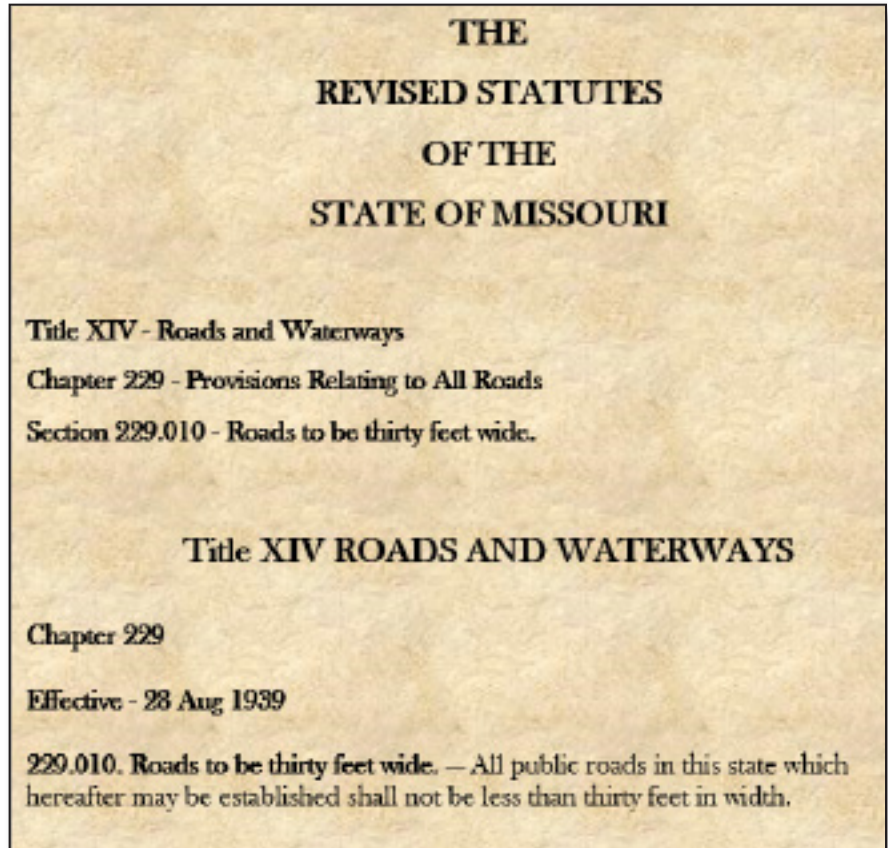

Missouri Revised Statute (RSMO) 229.010, which states that all public roads in the state in hereafter may be established and shall not be less than 30 feet in width. This is the lawful foundation of the county road system throughout the state.

In closing, there are a lot of people who do not know many of these documents exist. Some of these documents have been microfilmed by the Missouri State Archives and are available in their research room. If microfilmed, the county of record received a copy of the microfilm, with the originals either destroyed, put back on the shelf for posterity, or given to local county historical societies. Many counties who have not had these documents microfilmed still have the originals in their office closets or storage spaces. Even more don't even know that these documents are there or what they are.

If you have any questions concerning rights-of-way or document research, you can call Patrick Kliethermes at 573-694-9475 or by email at Kliethermesresearch@gmail.com. 🇲🇴





1835 S Stewart, Suite 124
Springfield, Missouri 65804
417-522-7870

Wilson Surveying Company is seeking an additional PROFESSIONAL SURVEYOR to perform property boundary surveys.

The Professional is expected to:

- Conduct deed and previous survey research on the subject tract and adjoining/nearby properties.
- Plan the project based on the research.
- Conduct a field search for existing monuments.
- Make measurements to determine the relative positions of the existing monuments.
- Determine the boundary.
- Prepare a plat of survey.
- Make appropriate records of the work.

The Professional may work with the client to develop a scope of services and a fee for the services. The Professional is expected to manage the project, so that a profit is realized, including providing assistance in the preparation of billing. The firm principals and administrative staff will assist with the business tasks.

The Professional in this position will have the opportunity to assist the Principals in managing additional professionals as the firm grows, and may have opportunity to become a principal.

We are a surveying firm with Land Planning and Engineering Services. Wilson Surveying focuses on property boundary work and work associated with development projects. The work includes meeting the requirements of planning and zoning and development regulations in our area. The provides opportunity for more challenging work and occasionally provides the opportunity to assist in boundary dispute resolution. There is an opportunity to conduct construction staking or construction control on the development projects, but we do not pursue construction staking on "heavy civil" work.

Experienced professionals seeking a change are encouraged to apply.

Wilson Surveying is located in Springfield, Missouri. Our clientele is concentrated in Greene & Christian Counties, but we also offer project services in the surrounding counties.

Forward your resume or inquiries to Mark Young, PLS & PE: Mark.Young@WilSurveyInc.com



BAX ENGINEERING IS HIRING!

PROFESSIONAL LAND SURVEYOR - OFFICE PROJECT MANAGER

Requirements:

- Professional Land Surveyor in State of Missouri (License in Illinois a plus, but not a must)
- Experience with AutoCAD Civil 3D preferable
- Experience with and willingness to perform survey drafting duties including: ALTA Surveys, Topographic Strip Maps, Rural and Urban Boundary Surveys, and MO Land Corner Documents
- Work with Director of Land Surveying to help check and sign house packages, easement exhibits, legal descriptions, elevation certificates and as builts

We offer a competitive compensation package with comprehensive benefits. Benefit package includes Health, Dental and Vision Insurance, 401K with matching program, Holiday Leave, Vacation Leave, Personal Leave, Flex Schedule, Long Term Disability, Professional Development opportunities and more.

Please submit your resume to
mcollins@baxengineering.com

MSPS Scholarship Recipient Eli Hayes



Meet Eli Hayes, our Robert Pirrie Memorial Scholarship recipient. Recently enrolled at Missouri State Technical College in Linn, Eli study civil engineering and land surveying.

Interactive Display About Surveying

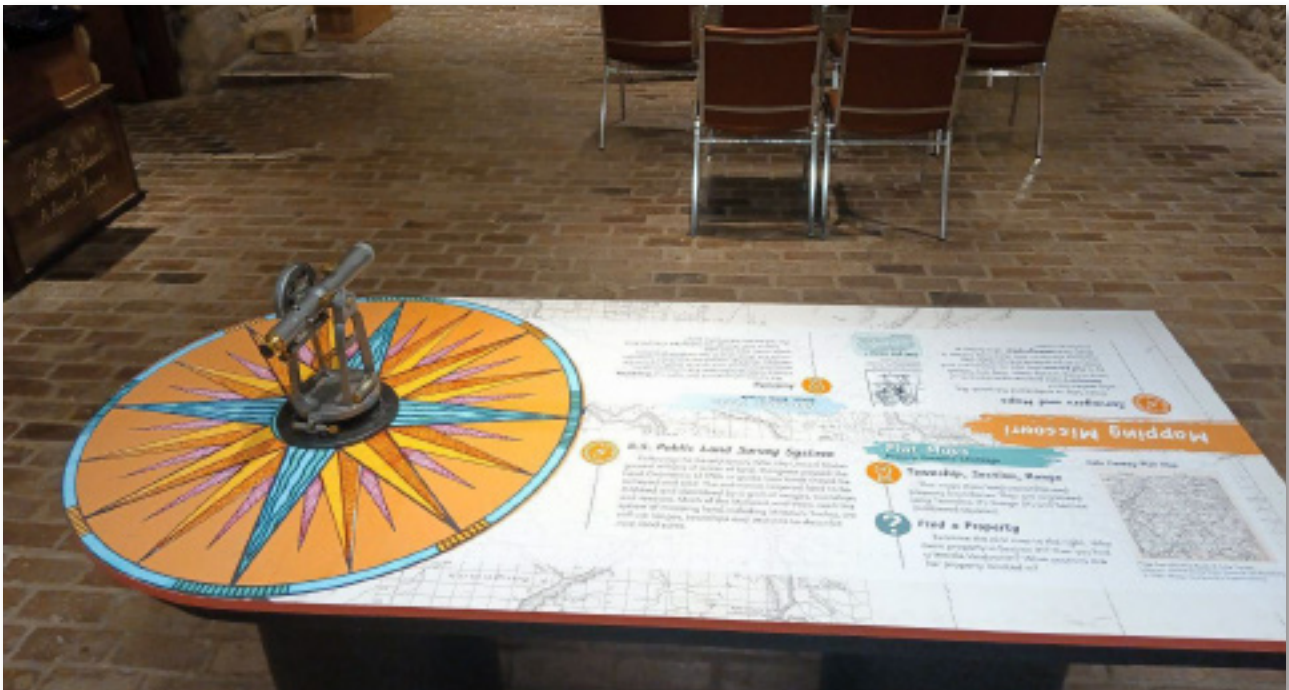

Interactive Survey Display at the Land Survey Program in the Lohmann Building (future Robert Myers Building) in Rolla. Note the rodman in the upper right. (photo from Matt Thomas) 



From data capture in the field to design and documentation in the office

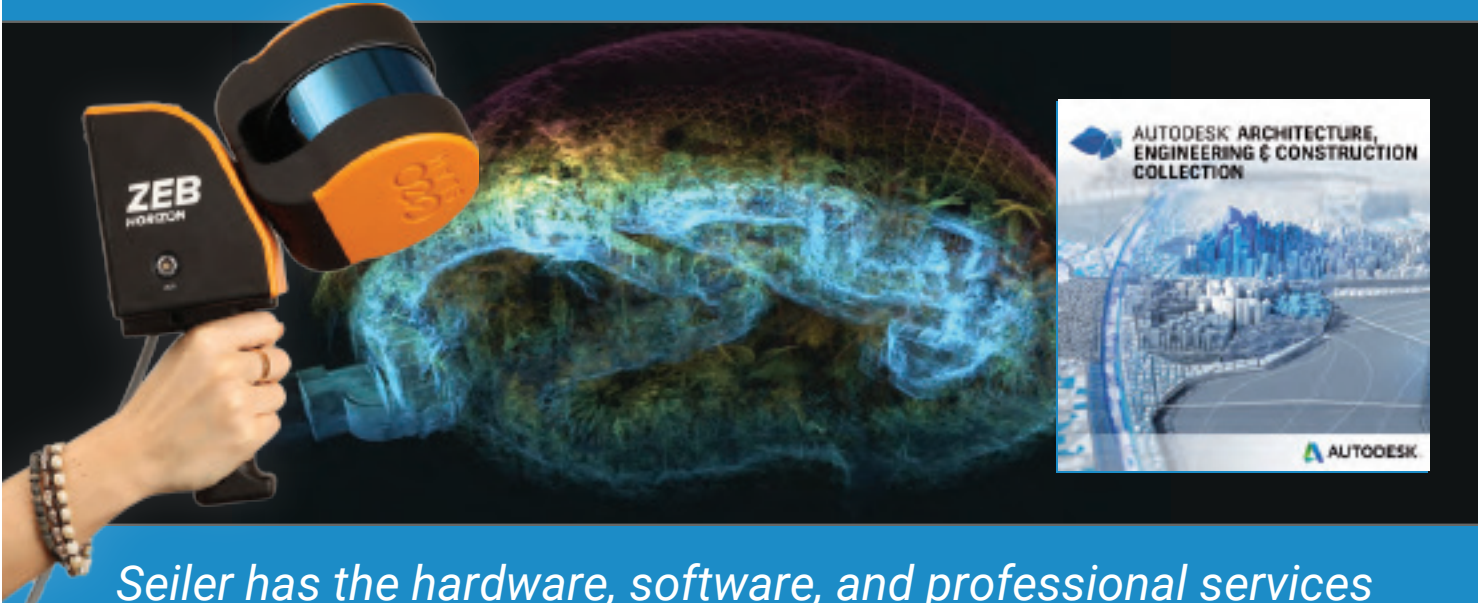

Seiler has the hardware, software, and professional services to keep you ahead of schedule and under budget.

PRODUCTS & SERVICES WE OFFER:

- Autodesk Software Solutions
- Handheld Scanners
- Hands-on Custom Training
- Template Creation
- Workflow Analysis
- Skills Assessment Testing
- Custom Content Creation
- Complete Support- before, during, and after every sale.
- Services and Sales via Seiler Geospatial; Robotic Total Stations, scanning, imaging, GNSS, and UAV Technology.



IOWA • ILLINOIS • INDIANA • KANSAS • MICHIGAN • MISSOURI • NEBRASKA • WISCONSIN

cad@seilerinst.com | 1-888-263-8918 | www.seiler-ds.com



NEWS & VIEWS *National Society of Professional Surveyors*

NSPS Spring Business Meeting and General Membership Meeting April 24-26, 2024, in Arlington, VA

NSPS, April 25, 2022

The 2024 NSPS Spring Business Meeting, held at the Arlington Hilton in Arlington, Virginia, welcomed directors, committee members, and guests from across the nation and Puerto Rico to perform the business of our professional association. Dozens of committee meetings were held prior to the Board of Directors meeting, with the goal of communicating our message to the attendees.

On Thursday night, April 25, we hosted a formal banquet to highlight the new NSPS officers being installed for 2024-25. The new officers are as follows:

- Davey Edwards — President
- Linda Foster — President-Elect
- Timothy Murphy — Vice President
- Robert Akins — Immediate Past President
- Craig Amey — Secretary
- Robert Miller — Treasurer

Surveying Profession Advocates Federal Policy During ‘Day on the Hill’

NSPS, April 23, 2022

On April 23, 2024, NSPS members advocated positions on licensing, monument preservation and TAP pilot for the 2025 defense bill before Congress as part of the NSPS “Day on the Hill.” More than 70 NSPS members from 42 states visited more than 125 members of the U.S. Senate and House of Representatives and their staff to discuss the role of the surveying profession in pending legislation. The voice of the surveying profession was heard loud and clear!

NSPS Government Affairs Activities Updated at Spring Meeting

NSPS, April 23, 2022

The NSPS Government Affairs Committee (GAC) met last month during the society’s Spring Business Meeting in Arlington, Virginia. During the session, NSPS Federal Lobbyist John “JB” Byrd provided highlights from the Government Affairs Update with numerous advances on key NSPS legislative priorities. Committee members discussed issues such as licensing, monument preservation, workforce development involving the military branches, the Davis-Bacon expansion to survey crews, the IMAGES Act and GPS interference.

NSPS Members ‘Day on the Hill’

NSPS, April 23, 2022

More than 70 NSPS members from 42 states visited more than 125 members of the U.S. Senate and House of Representatives and their staff to discuss the role of the surveying profession in pending legislation.



(continued on next page)

NSPS News & Views *(continued)*



Missouri NSPS Governor Reports on NSPS ‘Day on the Hill’

NSPS Director Mike Zahner attended the NSPS Day on the Hill with Logan Dowd, Kellan Gregory and Norm Ellerbrock. Altogether, NSPS visited 128 legislators and discussed the TAP Program, state licensures and state boards power as well as replacing monuments from natural disasters and railroad abandonment. Missouri student surveyors Kellan Gregory, Logan Dowd and Sarah Lovelady (see article on Page 4) participated in the 23rd Annual Student Competition where 22 teams participated in finding monuments in the DC area. 🇺🇸





We're Hiring!

PROFESSIONAL LAND SURVEYORS

St. Louis | Springfield/Ozark | Osage Beach | Farmington

Established in 1959, Cochran is a Civil Engineering/Land Surveying firm with six locations across Missouri. We are expanding our team and looking to add **licensed surveyors (PLS or LSIT)** to fill FULL-TIME positions at the above offices.

WHAT YOU BRING:

- Ability to perform survey calculations & read/comprehend plans
- Knowledge of AutoCAD & Civil 3D
- Knowledge of operating Total Stations, Data Collectors, RTK & GPS equipment
- Ability to coordinate field crews
- Ability to perform property & survey research
- Ability to complete ALTA Surveys, Boundary Surveys, Topographic Surveys & Construction Staking

OUR BENEFITS:

- Paid employee health, dental and vision & life insurance
- 401(k) matching
- Paid time off
- Paid sick time
- Paid holidays



To apply, scan the QR Code above or email your resume to cochrancareers@cochraneng.com

Cochran is an equal opportunity employer and does not discriminate against any employee or applicant for employment because of race, color, religion, national origin, age, disability, or any other reason prohibited under Federal, State or local laws. EOE AA/M/F/D/V.

We're Hiring!

claytoneng.com/jobs
(314)-692-8888

the clayton engineering company, inc.

ENGINEERS • SURVEYORS • PLANNERS

Professional Land Surveyor - Project Manager

We are searching for TWO Professional Land Surveyors to work on and manage projects primarily in the Greater St. Louis area, including Illinois.

Candidate Requirements

- Preparation of Proposals
- Boundary Surveys
- ALTA Surveys
- Construction staking calculations
- Survey crew & drafter coordination
- Project experience is required.
- Candidate must be a MO or IL Professional Land Surveyor.
- MSD As-Built drawing review & preparation
- Familiarity with Trimble Business Center and AutoCAD Civil 3D preferred.

Benefits Include:

- 100% paid employee healthcare
- 401K with contribution matching
- Employee Stock Ownership Plan
- Dental & Vision plans available
- Paid vacation, with rollover
- Great team environment
- Sick time, with rollover
- Flexible work hours
- Paid holidays

Since 1926!



Surveyors Materials, Inc.

8875 Frost Avenue
St. Louis, MO 63134
(314) 521-9041

Sales * Rentals * Service

**From Laths and Hubs to Robotics, Network GNSS
&
High Definition Scanners**

- when it has to be right



New Venue for Surveying Courses in Missouri

Missouri Surveyor

At the MSPS Board of Directors Meeting at Lake Ozark on May 1st, Joe Paiva reported State Technical College may be terminating their surveying courses this fall. In response to this potential (probable) loss, Dr. Paiva has instituted a nonprofit education facility for surveyors to get the needed courses for licensure. He is in the process of setting this up with the IRS and putting together a board of directors. This new venture is called Midwest Geospatial Academy and will be housed in Kansas City for the virtual courses. They are trying to find a location in central Missouri for the in-person labs. The website is www.geospatialacademy.us.



About MGA

Midwest Geospatial Academy (MGA) is a newly formed college to provide education for the surveying profession. It will launch by offering surveying coursework in August 2024. The school will offer hybrid courses for Surveying I and II as well as these fully online courses: Land Records: Researching and Using; Legal Aspects of Boundary Surveying; and the new fifth course, Elements of Surveying Practice. The courses have all been reviewed and approved as acceptable educational content for land surveying licensure by the Land Surveying Division of the Missouri Board for Architects, Professional Engineers, Professional Land Surveyors and Professional Landscape Architects (APEPLSPLA).

Contact info@geospatialacademy.us for more information or to be placed on the registration priority lists for the fall (Surveying I, Land Records and Elements of Surveying Practice).

For personalized answers, contact Joseph V.R. Paiva at joe@geospatialacademy.us. 🇺🇸

Special Announcement!

All surveying courses have been approved by the Missouri Board for Architects, Professional Engineers, Professional Land Surveyors and Professional Landscape Architects as acceptable surveying education for surveying license applicants. Below is the portion of the Missouri Board's list of acceptable courses for surveying applicants pertaining to MGA! The courses also fulfill the new requirement of 6 credits (semester hours) of legal aspects courses.

Midwest Geospatial Academy
(Online Courses – beginning with the Fall 2024 Term)
Attn.: Dr. Joseph Paiva
PO Box 7247
Kansas City, MO 64113

SUR 201 - Surveying I
SUR 202 - Surveying II
SUR 301 - Land Records: Researching and Using
SUR 302 - Legal Aspects of Boundary Surveying
SUR 303 - Elements of Surveying Practice

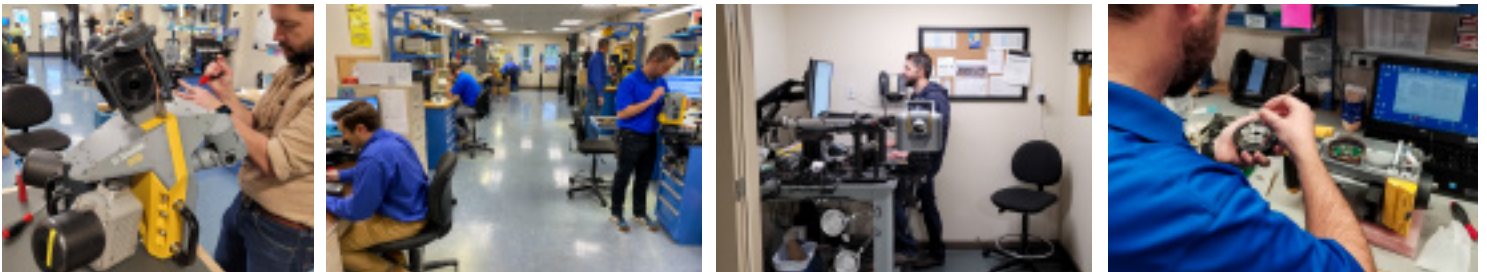

Make sure your instruments are in peak shape and get a free estimate!

Service and Repair

GPS/GNSS/GIS

Data Collectors • NIST Certification

Lasers (Pipe, Grade, Interior) • Levels

Mechanical Total Stations • Clean, Relube

Robotic Total Stations • Trimble Mobile LiDAR

Calibrate and Repair most makes and models

Email: servicedept@seilerinst.com

Toll Free: 877-330-6303

www.seilergeo.com



SCAN ME



Service Centers

ILLINOIS • INDIANA • KANSAS • MICHIGAN • MISSOURI • WISCONSIN

A Surveyors View of the Solar Eclipse

by Matt Thomas, PLS





April 8, 2024, the Great North American Eclipse arched its way across the continent from Mazatlán in Mexico to Moncton in the Maritimes with Missouri in its march. MSPS member Matt Thomas observed and reported – “[I] happened to be working in the Elephant Rocks/Tom Sauk/Battle of Pilot Knob area where we were fortunate enough to get a total eclipse.” He noted, “...streetlights came on, peepers started singing and the temperature dropped at least 10°.” 🇺🇸

Official Report of Guinness Record

by Ted Laneman, PLS



LAND SURVEYING
CIVIL ENGINEERING
CONSTRUCTION CONSULTANT
MOUNTAIN SPECIALIST
KARST SPECIALIST

9115 Delphine Avenue
ST. LOUIS, MO., 63114
314-772-4346

May 6, 2024
Project No: 2779
TRANSMITTAL

TO: MSPS
722 East Capitol Avenue
Jefferson City, Mo., 65101
Attn: Sandy B.; 573-635-9446
msps@missourisurveyor.org

RE: City Museum-Guinness Record Longest Shoelace Measurement
Eads Bridge over the Mississippi River
City of St. Louis, Mo.

Enclosed are the Guinness Record Photos, my Official Report and my Article for your use in the next newsletter, concerning our historic measurement on this historic bridge of the future next world's longest shoelace. I am the original land surveyor approached by Bob Cassilly to create his new vision, the City Museum, in 1997. My company was honored to be his only land surveyor until his untimely death in 2011. Our implementation of his ideas and genius challenged every element of my training and experience. Standing and working in the light of his genius was the greatest time in my life and career. I was honored to soak up and absorb his creativity, drive, kindnesses to all children, and construction miracles. I am told by his incredible artisan crew that some of that has rubbed off on me. I definitely have changed for the better as a result. We Land Surveyors hardly get any recognition or respect for our services and efforts, so this Guinness World Record Longest Shoelace Measurement for me, reminds the World that good old Missouri, crazy old St. Louis, and the City Museum still have it going on. Keep watching for more.

Thank you for your examples of organization at our seminars, and your help with this Land Surveying event.

Respectfully submitted:

Ted Laneman



T.L. CONSULTANTS
LAND SURVEYING 8118 Delshire Avenue
CIVIL ENGINEERING ST. LOUIS, MO. 63114
CONSTRUCTION CONSULTANT 314-772-4906
MOUNTAIN SPECIALIST THEODORE E. LANDSHAL, JR.
KARST SPECIALIST MO. LS-22318



PN: 2779

(continued on next page)

Official Report of Guinness Record (continued)



LAND SURVEYING
CIVIL ENGINEERING
CONSTRUCTION CONSULTANT
MOUNTAIN SPECIALIST
KARST SPECIALIST
9115 Delphine Avenue
ST. LOUIS, MO, 63114
314-772-4346

Project No: 2779

This is to certify that we have, during the month of April, 2024, by order of Maria Cassilly with the City Museum, made a Survey in accordance with the current Minimum Standards for Property Boundary Surveys of the Missouri Department of Agriculture of a Guinness World Record measurement of the World's longest shoelace. This measurement took place on the South pedestrian walkway of the Eads Bridge over the Mississippi River. This walkway is relatively level and is a very long straight alignment. The floor surface of the bridge is a parabolic arc which required precise measurements every 70' on the shoelace. These measurements were reduced to the true ground distances on this parabolic arc. All measurements were taken with a Topcon GTS-211D, recently calibrated and having a 2 second angular accuracy. April 15, 2024, was the date of this measurement. Air temperature was 85 degrees with minimal wind conditions. The shoelace remained undisturbed during these measurements. This survey was executed in accordance with the standards for an Urban Survey.

The official length of this shoelace is 2,729.360' US ft, or 0.517 mile, or 831.911 meters.

This survey was executed in accordance with the standards for an Urban Survey.

Survey by: T. Laneman Jr.

Survey No: 2779

T. L. CONSULTANTS

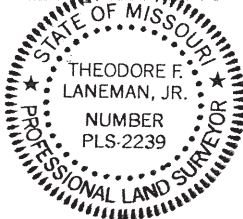

In witness Whereof, I have hereunto set
my hand this 15th day of
April, 2024.

Theodore F. Laneman Jr.
THEODORE F. LANEMAN JR. L.S. 2239



LAND SURVEYING
CIVIL ENGINEERING
CONSTRUCTION CONSULTANT
MOUNTAIN SPECIALIST
KARST SPECIALIST
9115 Delphine Avenue
ST. LOUIS, MO., 63114
314-772-4346

May 6, 2024
Project No: 2779

GUINNESS RECORD WORLD'S LONGEST SHOELACE MEASUREMENT
for The City Museum in the City of St. Louis, Missouri

In early April, 2024, I received a text from a dear friend who works at the City Museum. She is Maria Cassilly and is the wife of Bob Cassilly's son Max. Bob Cassilly is the genius and visionary who transformed the vacant textile Building known as the Internation Building into the dazzling and artistically unique place we now know as the City Museum in the City of St. Louis. Like all of the texts and calls from the people at the City Museum that I have gotten over the last 27 years, hers matched up to some of Bob Cassilly's most challenging requests. Would I and my company be willing to do a Guinness Record Official Measurement to certify the length of the World's Longest Shoelace, created and made by the City Museum. Wow, is there such a thing? Of course, and the people at the City Museum know just about everything unique.

I had too many questions to text back and forth so I called Maria. I expressed my excitement to do this measurement and had lots of very specific questions about the Guinness Record rules and procedures. She explained that they first require a registered Land Surveyor to perform the measurements and certify to the official results. Their more specific rules dictated that there is no tension on the shoelace, cant be disturbed while the measurements are being taken, the measuring surface must be relatively level and in a straight alignment. No bends or corners will be allowed. No problem so far. I then asked how long this shoelace needs to be. One hundred feet, two hundred feet? She laughed and said 1810' and much longer. Now I laughed. More questions on the logistics of this immediately came to mind. We agreed to both reflect on these facts and get back in touch with each other soon.

Four days later we reached out and began to strategize this event. After many sites being studied where we could do this measurement and not have cars running over the shoelace, my suggestion was going to be the sidewalk along the South side of Lindell Avenue in Forest Park. It was very level and had no traffic crossings running to the East all the way to the Missouri History Museum. It would meet the required distance safely. The City Museum of course had the best idea. They want this measurement to be done on the Eads Bridge over the Missouri River after morning rush hour, seven days away. Wow. Bob Cassilly would be so proud. What a very St. Louis, City Museum epic event.

A little back history next. Why would the City Museum call me out of all the Land Surveying companies in St. Louis? My company had been actively involved with the early Building renovations and condominium conversions in that area along Washington Avenue since 1994. At that time the area was a high crime area and real estate development was nonexistent. One of my first historic skyscraper renovation projects was the Art Loft at Washington and 16th Street. This was located across the Lucas Street alley from the future City Museum. This was the first HUD Building project in the area and the proposed occupancy required a set number of parking spaces for the site to be approved. The HUD officials somehow negotiated a deal with the City Museum property to take away a large part of their parking lot to use for this HUD site.

(continued on next page)

Official Report of Guinness Record *(continued)*

They did pay a monetary compensation for these parking spaces. Bob Cassilly was furious and I was told he wanted to know who T.L. Consultants is. A year later my company was asked to coordinate and move a 100 ton three story house from the road widening then happening at Hwy 141 at Manchester Road. This was a huge spectacle and was filmed by all the news channels. This house was moved an eighth of a mile south on Old Highway 141 and then an eighth of a mile west on Manchester Road. Bob saw it on TV and then wanted me to help him create a place to be known as the City Museum.

Since that time I and my company have been so honored to work personally with Bob Cassilly, his staff and artisan crew through all of their outstanding art creations, and innovative use of architectural Buiding pieces. His art sculptures, gardens and installations in other locations are now world famous. I pinch myself all the time and see how incredible the City Museum has become and is second in attendance to the Gateway Arch. To be involved with a true artistic genius was a life changing experience for me. As a Land Surveyor trying to keep up with him was always challenging and usually mind blowing. Not many people know that the City Museum is a one of kind Amusement Condominium. Bob's imagination said why cant we use condominium tax laws and practices and make a new precedent? It took myself and a team of attorneys months to craft this new entity. It is now legal and the first in the City of St. Louis, the first in the State of Missouri, and the first in the United States. Wow, the City Museum factor shines out. On the last meeting day to finalize this historic new precedant we were creating, I parked on Delmar Avenue and was going to walk down the 15th street dock where my friends worked. Before I left Delmar Avenue, there was a huge commotion on this sidewalk, blocking the way. Only at the City Museum would Flora the Asian Elephant be there stretching her legs on the sidewalk with her trainer. The circus was in town for that week and guess where they had permission to hang out. I got to give her a treat and was late to the final attorney meeting. There now is such a thing as an Amusement Condominium. There is much more to these stories.

My company was honored to be his only land surveyor until his untimely death in 2011. Our implementation of his ideas and genius challenged every element of my training and experience. Standing and working in the light of his genius was the greatest time in my life and career. I was honored to soak up and absorb his creativity, drive, kindnesses to all children, and construction miracles. I am told by his incredible artisan crew that some of that has rubbed off on me. I definitely have changed for the better as a result. We Land Surveyors hardly get any recognition or respect for our services and efforts, so this Guinness World Record Longest Shoelace Measurement for me, reminds the World that good old Missouri, crazy old St. Louis, and the City Museum still have it going on. Keep watching for more.

Respectfully submitted;

Theodore F. Laneman Jr. PLS

Complete Your Carlson Software Toolbox Today!

Ask your Laser Specialists Representative about these products!



Survey

Powerful Field-to-Finish, Office Platting and Drafting Software, Now with Improved Autodesk Civil3D® and/or MicroStation® DGN Support



Point Cloud

Turn your point cloud data sets into usable models quickly and easily with Point Cloud Basic or Point Cloud Advanced



SurvCE/SurvPC

Powerful Field Data Collection Software with Extensive Equipment Support, Now with Hybrid



BRx7

Flexible, Powerful GNSS receiver with 800+ channels, tilt compensation, and field-proven performance



GIS

From aerial imagery to data capture, Carlson GIS is the GIS "Swiss Army Knife" for the surveyor



Laser Specialists Inc

www.LaserGPS.com

Matt Todd
(417) 371-1927

Kevin Lindsey
(417) 208-6629

Education for the Professional Surveyor

Addressing Deficiencies and Coursework needs to the NCEES Exam

by David J. Sherill, PS – 3/24/2024



It was with great interest to read Knud E. Hermanson's last Article 11 in the Missouri Surveyor, a quarterly publication of the Missouri Society of Professional Surveyors, in which Mr. Hermanson addressed several issues dealing with deficiencies in student education at Universities across America.



The article was timed well for a response with the newly approved Land Surveying and Geomatics Bachelor's Degree Program at SIUE. The new program was developed to address those deficiencies mentioned in Mr. Hermanson's article, and more.

The new program was also built around the exam specifications described in the NCEES Surveying Sample Questions and Solutions Booklet for both the FS and PS Exams.

This article was prepared to compare the new curriculum in Land Surveying and Geomatics Program coursework at SIUE to the knowledge areas specified in the NCEES FS Exam, and to illustrate the comprehensive approach of the program in addressing all areas of knowledge needed to successfully pass the FS exam and to better prepare the graduate on his or her journey through mentoring under a licensed surveyor to become a well-qualified licensed surveyor and geospatial professional.

The coursework as shown in the Sample Curriculum for the new program at SIUE covers all sections of the NCEES FS exam specifications which includes, but is not limited to the following:

Section 1

Surveying Processes and Methods

16-24 Questions

- This section covers Instrumentation, GNSS/GPS, Control surveys, Accuracy standards, Cadastral, PLSS, Boundary, Topographic, Construction, Land Development, Field Records, and Data files.
- Coursework associated with this section is Surv 264, Cnst 415, Surv 482, and Surv 484 in the sample curriculum.

Section 2

Mapping Procedures and Methods

14-21 Questions

- This section covers Mapping concepts, Plats, Alta, Topographic, CAD, BIM, GIS, Digital Terrain Model, Photogrammetry, Remote Sensing, UAS, Drone, Analysis and Processing.
- Coursework associated with this section is Geog 111, Ce 204, Geog 210, Geog 320, Geog 322, Geog 418, Geog 422, Surv 482, Surv 484 and Surv 486 in the sample curriculum.

Section 3

Boundary Laws and Real Property Procedures

19-29 Questions

- This section covers Public Records, Descriptions, Common Law Principles, Easements, Conveyances, Metes and Bounds, PLSS, Riparian, Sources of Law, Encumbrances, Real Property.
- Coursework associated with this section is Surv 264, Surv 310, Surv 364, and Surv 495 in the sample curriculum.

Section 4

Surveying Principles

13-20 Questions

- This section covers Basic Surveying, Geodesy, Applied Geodesy
- Coursework associated with this section is Surv 264, Surv 482, Surv 484, and Surv 485 in the sample curriculum.

Section 5

Surveying Computations and Computer Applications

17-26 Questions

- This section covers Coordinate Geometry, Traverse, Closing and Adjustments, Leveling, Least Squares, Area, Horiz. and Vert. Curves, Volumes, Spreadsheets, and Graphs.
- Coursework associated with this section is Math 125, Math 150, Stat 244, Surv 264, Surv 310, and Surv 484 in the sample curriculum.

(continued on next page)

Education for the Professional Surveyor (continued)

Section 6

Business Concepts

11-17 Questions

- This section covers Project Planning, Safety, Liabilities, Contracts, Supervision, Project Documentation, Ethics and Communications.
- Coursework associated with this section is RA 101, Eng 102, ACS 103, Econ 111, Econ 112, Acct 200, Acct 210, Fin 320, GBA 383, Cnst 403. Cnst 411 in the sample curriculum.

Section 7

Applied Mathematics and Statistics

10-15 Questions

- This section covers College Mathematics, Probability and Statistics, Measurement Sciences and Quantitative Reasoning.
- Coursework associated with this section is Math 125, RA 101, Math 150, Stat 244, and Surv 484 in the sample curriculum.

The coursework listed in the Sample Curriculum with its encompassing 126 credit hours shows how extensive the study is in Land Survey, Business, Computations, Mathematics, Geography, Geospatial, and related sciences.

It is important for the Survey Professional to understand that, with the technological advances and expanding geospatial sciences, Surveyors must embrace expanded educational training.

Design professions across America require Engineers, Architects, and Structural Engineers to have a bachelor's degree to become licensed in each state. There is even a push to require a master's degree in certain areas of Design.

(continued on page 38)

Sample Curriculum for the Bachelor of Science in Land Surveying & Geomatics			
	Fall Semester	Spring Semester	
Year 1	CNST 100 Introduction to Construction or GEOG 101 Introduction to Geography	2 SURV 284 Fundamentals of Surveying	4
	ENG 101 English Composition I	RA 101 Reasoning & Argumentative	3
	MATH 125 Pre-Calculus/Trigonometry (BPS)	3 ENG 102 English Composition II	3
	CE 204 Engineering Graphics	3 MATH 150 Calculus I (QF, BPS, DNSM, INSM)	5
	CHSM 100A Gen, Org, and Biological Chemistry (BPS)	3 ACS 103 Interpersonal Communication Skills (EUSC)	3
	CHSM 104A Gen, Org, and Biol Chemistry Lab (EL)		Total Credits 15
	FST 101 First Semester Transition		1
	Total Credits 30		
Year 2	CNST 211 Civil Construction Materials & Methods	3 GEOG 210 Physical Geography (BPS, DNSM, EL)	3
	ECON 111 Macroeconomics (BSS)	3 ECON 112 Microeconomics (BSS)	3
	SURV 310 Legal Aspects of Surveying	3 SURV 364 Boundary Surveying	3
	GEOG 282 Natural Resource Management and Sustainability (BLS, DNSM)	3 PHYS 131 College Physics (BPS)	4
	STAT 244 Statistics (BGS)	3 PHYS 131L College Physics I Laboratory (BPS, EL, INSM, LNSM)	1
	Total Credits 30	Total Credits 14	
Year 3	CNST 341 Plans & Specifications	3 SURV 400 Internship	3
	ACCT 200 Fundamentals of Financial Accounting	3 ACCT 210 Managerial Accounting	3
	MGMT 330 Understanding the Business Environment	3 MGMT 331 Managing Group Projects	3
	GEOG 323 Cartography	3 GEOG 322 Air Photo Interpretation	3
	Breadth Fine and Performing Arts (BFPA)	3 GEOG 321 Quantitative Techniques (BGS, EL)	3
	Total Credits 15	Total Credits 15	
Year 4	GEOG 422 Remote Sensing	3 CNST 411 Construction Contracts	3
	FIN 320 Financial Management & Decision Making	3 CNST 462 Construction Management	4
	SURV 482 ADV Survey Systems & SR Assignment	4 SURV 464 Survey Computations & Applications	4
	GEOG 418 Geographic Information Systems	3 Surveying Elective (choose from list)	3
	Survey Elective (Choose from list)	3 GBA 383 Business and Society (BS, BGC)	3
	Total Credits 16	Total Credits 17	
		Total Hours 126	

Approved Electives		
Surveying Electives can be used for either a GIS or Construction Management Minor		
GIS Minor Surveying Electives	Construction Management Electives for Surveying	Surveying Technical Electives
GEOG 424 Computer Mapping	CNST 433 Planning and Scheduling	SURV 481 Computer Mapping & Applications
GEOG XXX Core Additional Approved Course for Minor	CNST 425 Heavy Civil	SURV 485 Geospatial Techniques
	CNST 432 Design Build Process	SURV 486 Drone Mapping and Applications
	CNST 442 Building Information Modeling	SURV 482 Route Geomatics and Design
	CNST 484 Project Controls	SURV 485 Hydrographic Surveying and Applications

Transfer Students: To maximize your transfer experience, complete the bolded courses/requirements pre-transfer and set up either the Illinois Articulation Initiative (IAI) General Ed Core or receive an AA, AS, or AAT (early childhood, special ed or math) degree from an IAI community college. If "Minor" requirements are shown, discuss careful course selection with the academic advising contact listed. Visit slu.edu/transfer to find course equivalency guides.

Contact Information
 Department of Construction, Land Surveying & Geomatics Program
 School of Engineering
 Phone: 618-660-2088

This information is concurrent with the 2021-2022 Academic Catalog. Courses are subject to change at any time.



Surveyors Rendezvous 2024



GLO: The Prairie Years

September 18-21, 2024

Hotel Julien - Dubuque, IA

Dubuque, Iowa's oldest city and one of the earliest settlements west of the Mississippi River, traces its origins to French-Canadian fur trader Julien Dubuque, who arrived in 1785. At that time, the region was inhabited by the Mesquakie (Fox) Indians, who guarded the secret locations of abundant lead mines, recognizing its value to Europeans. Developing a rapport with the Mesquakie through fur trading, Dubuque gained knowledge of the rich lead deposits and collaborated with them to extract the resource. Eventually, he gained control over the mines, which he named the Mines of Spain, and operated them successfully until his death in 1810.

In 1833, under the Black Hawk Purchase Treaty, the land Dubuque had developed became open for settlement by the United States Government, leading to the establishment of the city of Dubuque in 1837.

Situated along the Mississippi River and endowed with fertile land and plentiful resources, Dubuque attracted a wave of immigrants, particularly Irish and Germans seeking a better life away from the overcrowded east coast cities. Referred to as the "Key City" by those who saw it as the gateway to their aspirations, Dubuque became a hub for various industries such as mining, fur trading, button making, boat building, logging, mill working, and meat packing. Over time, it evolved into a thriving center for manufacturing, retail, healthcare, education, and employment, serving as the nucleus of the tri-state area.

Great speakers at this year's Rendezvous will share the early history of the state boundaries of Iowa, Missouri and Minnesota, as well as the nearby Principal Meridians. A trip to the "Field of Dreams" movie site, complete with a Surveyor's Olympics, will be a highlight of the Rendezvous.

We are returning to our Rendezvous roots by having a Show & Tell or Buy & Sell meet on Friday. Bring items to share. We'll cap things off with an optional river boat cruise on Saturday.

Fall in the upper Midwest is a great time of year. We look forward to reuniting with old friends and forging new connections.

Milton Denny, PLS
Mdenny5541@aol.com

Richard Leu, PLS
richleu@yahoo.com

Program

Wednesday, September 18

- ◆ Board of Directors Meeting
- ◆ Welcome Reception (Cash Bar)
- ◆ Annual Membership Meeting

Thursday, September 19

- ◆ Education Sessions (5 hours)*
- ◆ Lunch at the Hotel
- ◆ Field of Dreams Outing with Dinner

What's the best thing about Rendezvous? The people! Join us each evening in our *Hospitality Room* to share a beverage (adult or otherwise) and catch up with old friends.

Friday, September 20

- ◆ Education Sessions (4.5 hours)*
- ◆ Lunch at the hotel
- ◆ Show & Tell, Buy & Sell Swap Meet
- ◆ Social Hour, Annual Banquet, Raffle and Auction (Cash Bar)

Saturday, September 21

- ◆ Optional Outing - Mississippi River Museum & River Cruise with Lunch

**Individual licensees are responsible for determining if specific educational sessions are acceptable for license renewals in the jurisdictions where they practice.*



Spouse/Guest Program

- ◆ **Wednesday:** Welcome Reception and Annual Membership Meeting
- ◆ **Thursday:** Tour of Dubuque with Lunch and Field of Dreams Outing
- ◆ **Friday:** Tour of Galena, Illinois with lunch and Annual Banquet

Hotel & Airport Information

Hotel Julien

200 Main Street
Dubuque, IA 52001

- ◆ The Rendezvous room rate is \$139 (single/double) per night plus tax. Parking is complimentary.
- ◆ To reserve your room, call the Hotel Julien directly at 800-798-7098 or 563-556-4200 and mention Surveyors Historical Society. A valid credit card is required at the time of booking.
- ◆ The Rendezvous rate is valid until August 11, 2024 or until the room block sells out.

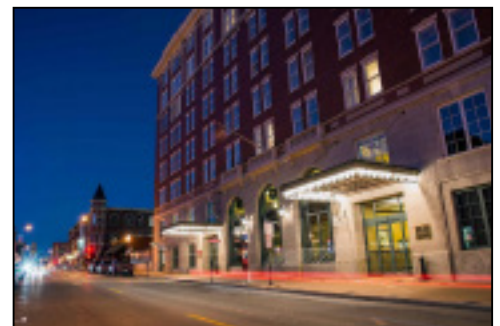

Airports

There are two regional airports less than 100 miles from Dubuque: Quad City International Airport (MLI) and Cedar Rapids (CID). Both are approximately a 90-minute drive to Dubuque. There is no public transportation to Dubuque from either airport.

Presentations & Speakers

Wednesday, September 18

Finding the Charcoal Mounds – Milton Denny, PLS

Thursday, September 19

Beginning of the GLO – Ann Besch, PS

The Fifth Principal Meridian: Its PM and Its Errors – Dick Elgin, PhD, PE, PLS

Uniquely Iowa: Surveys Between the Rivers – Greg Chlebicki, PLS, PE

The South Line of Iowa/North Line of Missouri – Darrell Pratte, PLS

The Iowa/Minnesota Border – Don Borcharding, PLS

Friday, September 20

GLO: The Prairie Years - Instructions and Practice – Milton Denny, PLS

The History of Dubuque Surveys and Lead Mines – Jeff Brandt, PLS/RLS & Hugh McCarron

History of Australian Surveyors until 1824 – John Brock, PLS

Letters of the GLO – Rich Leu, PLS

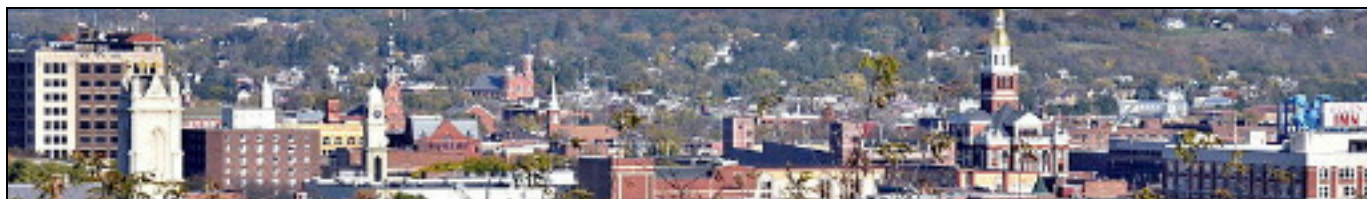

Rendezvous Highlights

Field of Dreams

Thursday, 4:30 to 7:30 pm

A trip to the Field of Dreams is included in the full and spouse/guest registration packages. Activities will include a chance to run the bases and a measuring competition on the field. A ballpark dinner will be provided at the concession stand. Bring your ball and glove. You might “want to have a catch”.

Show & Tell or Buy & Sell

Friday, 2:00 - 5:00 pm

This year’s Rendezvous will feature a Swap Meet and instrument appraisals. David Ingram will be on hand to appraise instruments or provide an estimate for repair. Six Solar Compasses will be on display plus many other artifacts. Remember to bring your items to swap or sell.

Optional Outing - Mississippi River Museum & River Cruise with Lunch

Saturday, 8:30 am - 2:30 pm

This optional outing includes time to tour the Mississippi River Museum and Aquarium and a two-hour cruise along the Mississippi River with a buffet lunch of roast beef, fried chicken, mashed potatoes/gravy, corn, and pasta salad (subject to change). Transportation is included.

Acoustic Music Sessions

Attendees are encouraged to bring their acoustical instruments for songs and stories after hours.

The Proposal to Modify the NCEES Model Law and Rules

by NSPS President Robert Akins

A request for NSPS state affiliates to endorse or not endorse proposed changes to the NCEES Model Law proposed by a work group from URISA has resulted in tremendous confusion.

There were some misstatements along the way resulting in misunderstandings over the proposal and process. We would like to turn the temperature back down to normal.

The Ad Hoc committee formed by NSPS last fall (chaired by Gary Kent and including NSPS President-elect Davey Edwards, NSPS Vice-president Linda Foster, and NSPS Past-president Amanda Allred) was charged with studying the URISA proposal and formulating a motion to be considered by the NSPS Board of Directors this coming April.



After receiving comments from the states and reviewing the proposal, the Ad Hoc committee will be recommending that the Board of Directors not endorse the URISA proposal.

For those interested, they can read more further below under “Background,” but for those interested, here are three important points followed by a short explanation:

- 1. Despite some communications that left this in question, this was not an NSPS initiative.*
- 2. NSPS has not been working with URISA on this, and NSPS did not develop, or even participate in developing, this proposal.*
- 3. NSPS is not ‘promoting’ this proposal*

This issue came to NSPS in the form of a simple request from an informal working group of URISA asking NSPS to give a thumbs up or thumbs down to its proposed revisions to the NCEES Model Law and Rules. It was not developed by any NSPS committee or otherwise. It is not something that NSPS is trying to promote or force upon the states.

There have been accusations as to the process that imply some sort of conspiracy and even corruption. There have been comments asking how long NSPS has been working on this proposal without the memberships’ knowledge. There has been a threat from one that he may suggest his state pull out of NSPS. These are all the result of miscommunications as to what actually transpired.

Such comments and other similar accusations are taken very seriously, but unfortunately they reflect gross misunderstandings rooted, to some extent, in our own miscommunications.

To reiterate, an informal working group from another organization spent 2 years working on a proposal and they simply wanted NSPS to endorse their work, or not. That’s it. No conspiracy. No corruption. No behind-the-scenes attempt to orchestrate an end run.

In April, the NSPS Board will be considering a motion to not endorse the proposal.

Background

Having been intimately involved with the Urban and Regional Information Systems Association (URISA) Policy Advisory Committee’s (PAC) workgroup on the NCEES Model Law and Rules since day one, and regrettably, not being able to attend the NSPS fall meetings in Cleveland when this item was discussed, Gary Kent wanted to take this opportunity to clarify exactly what has transpired. His comments follow.

By way of background, in about 1997 the American Society for Photogrammetry and Remote Sensing (ASPRS) convened a GIS-Surveyor workgroup to try and distinguish between what practices in GIS constituted the practice of surveying, and what did not. For the most part, its work was adopted by NCEES in 2003, primarily as an addition to the Model Rules.

A few years ago I was invited to participate in the URISA Policy Advisory Committee (PAC) as a surveyor representative. I was

not invited as a representative of NSPS, but simply as a well known member of the surveying community who has been involved in and spoken on, GIS including at several URISA and Esri conferences.

At some point during the last several years, an informal “GIS-Surveyor workgroup” was spun out of the URISA PAC in order to explore the NCEES Model Law and Rules. The objective of the workgroup was to understand how the evolution of technology and practices have served to further muddy what aspects of GIS constitute the practice of surveying and to develop a proposal to take to NCEES to modify the Model Law and Rules accordingly. I was asked to participate in the effort, which was distinctly and exclusively a URISA initiative.

The evolution in technology and practices is not something that the original 1997 work group could have anticipated. It has, among other things, exposed deficiencies in the Model Law and Rules and resulted in litigation due to confusion in the wording of state laws defining the practice of surveying.

In addition to the need to address the surveying/GIS issues, I told the workgroup that I was aware of other concerns that well-known surveyor and attorney Jeff Lucas and I share about the Model Law. Members of the workgroup encouraged me to explore those issues with Mr. Lucas and propose wording, which I did. Those changes were also included in the proposal.

As the URISA workgroup proceeded in its work the conversation eventually turned to how to present the proposal to NCEES. It was my suggestion that any such proposal would likely receive a better reception if it came from the surveying community rather than from the GIS community, even though we believed both would benefit from it. The possibilities of an NCEES state surveying delegation or NCEES Zone being the best conduit were discussed. During the conversation, it was also suggested that it would be even better received if NSPS would be willing to endorse the proposal.

The reader needs to understand that at that point in time, the plan was for the URISA workgroup’s proposal to be taken to the NCEES regardless. This was in no way intended to be an end run around NSPS because the reader also needs to understand that NCEES is almost perpetually working on its Model Law and Rules and, to my knowledge, none of those proposals have ever formally or informally been run through NSPS for its input (with the possible exception of the work of the 1997 workgroup).

Once it was determined that it would be desirable to have NSPS sign on to this URISA proposal, the workgroup decided to invite NSPS Executive Director Tim Burch to attend the workgroup meetings (all virtual), so he could understand the process that had been undertaken, the work that had been done, and so he could consider the best way to get the proposal in front of NSPS for its consideration.

By this time, after several years of very intense and, what I proudly report was, exceptionally collaborative work between a dedicated group of URISA members and an equally dedicated group of surveyors (five of the nine persons eventually involved in the workgroup were, in fact, surveyors, all of whom are likely members of NSPS, but none of whom were representing NSPS), and approaching a final proposal, the workgroup felt it was beyond looking for NSPS to wordsmith or propose changes to its work. It simply wanted to offer NSPS the opportunity to sign on to it, or not. Those were essentially the parameters that Tim was given.

As was suggested in another letter, Mr. Burch most assuredly did not “make policy decisions, including negotiations on a pretty damned important topic, with an unrelated organization.” It was not his proposal; he did not make policy decisions, nor did he participate in any “negotiations.” He was simply extended the courtesy to take another organization’s proposal to NSPS to endorse, or not. If Tim made a mistake on how to achieve URISA’s hope of an NSPS endorsement, it was rooted in miscommunication which was likely the result of an unconventional charge, not for lack of good faith. Had I been able to attend the Fall NSPS meeting, this could have all been avoided, but I had a conflict resulting in me missing my first fall meeting since 1982. 🇺🇸

Contact President Akins for more information (twogunpete@reagan.com)



MISSOURI SOCIETY OF PROFESSIONAL SURVEYORS

THE NEW, IMPROVED AND EXPANDED

SURVEYOR'S REVIEW COURSE

AUGUST 12 - 14, 2024

Missouri Chamber Building | 428 E. Capitol Avenue | Jefferson City, MO

MONDAY, AUGUST 12TH

9:30 am - 5:00 pm

(30-minute lunch break - lunch provided)

SURVEYING MATH

Basic Surveying Math | Coordinate Geometry | Surveying Math Applications | Errors

TUESDAY, AUGUST 13TH

8:00 am - 4:30 pm

(30-minute lunch break - lunch provided)

SURVEYING FUNDAMENTALS

State Plane Coordinates | Riparian Boundaries | Boundary Descriptions | Curves | GPS & GIS | Legal Aspects

WEDNESDAY, AUGUST 14TH

8:00 am - 3:30 pm

(30-minute lunch break - lunch provided)

EMPHASIS ON MISSOURI

Standards | Rules | Statutes | Chapter 60 | USPLSS for Missouri

PRESENTERS

Dr. Joseph Paiva, PLS, is a geomatics and business development expert and a former university educator, who is now CEO and Principal of GeoLearn (www.geo-learn.com), an online education company specializing in courses for professionals and technicians in the geospatial industry. *Dr. Dick Elgin, PLS, PE*, works for Archer-Elgin Engineering, Surveying & Architecture (Rolla). He authored "The U.S. Public Land Survey System for Missouri" and "Riparian Boundaries for Missouri". *Mike Flowers, PLS*, is the former Missouri State Land Surveyor. He is a former member of the Missouri Board of Architects, Professional Engineers, Professional Surveyors and Landscape Architects.

The Surveyor's Review Course is appropriate for those who will be taking any part of the surveying licensing exams, or for those already licensed and wish to review surveying topics and receive PDUs.

The course has been approved for continuing education credits from the Missouri Board for Architects, Professional Engineers, Professional Land Surveyors and Landscape Architects for the following hours:

Monday 7.0 PDUs Tuesday 8.0 PDUs Wednesday 7.0 PDUs

Note: If you are currently licensed in Missouri, all 7.0 PDU's on Wednesday are applicable for the 2 hour PDU requirement for license renewal per 20 CSR 2030 8.020 (Missouri Standards and Statutes).

MISSOURI SOCIETY OF PROFESSIONAL SURVEYORS

THE NEW, IMPROVED AND EXPANDED

SURVEYOR'S REVIEW COURSE

AUGUST 12 - 14, 2024

Missouri Chamber Building | 428 E. Capitol Avenue | Jefferson City, MO

LOCATION AND LODGING

The Review Course will be held at the **MISSOURI CHAMBER BUILDING, 428 E. CAPITOL AVENUE, JEFFERSON CITY, MO 65101**, in the auditorium. A block of rooms has been reserved at the **COURTYARD BY MARRIOTT, 610 BOLIVAR STREET, JEFFERSON CITY, MO 65101**, at a rate of **\$139.00**. Make your reservations by calling **573.761.1400** and refer to the "Missouri Society of Professional Surveyors Review Course" rate when reserving your room. **THE DEADLINE TO MAKE YOUR HOTEL RESERVATION IS SUNDAY, JULY 14, 2024.**

LUNCH

The program will break for 30-minutes each day and lunch will be provided. Lunch is included in the registration fees.

CANCELLATION POLICY

MSPS reserves the right to cancel the program and return all fees in the event of insufficient registration. A participant may cancel a registration up to two weeks before the course date and receive a refund, minus a \$25.00 service charge. **NO REFUNDS WILL BE GIVEN AFTER MONDAY, JULY 29, 2024.**

FEE SCHEDULE (Please check appropriate boxes)	MSPS MEMBER	NON MEMBER
<input type="checkbox"/> ALL THREE DAYS	\$1,100	\$1,400
<input type="checkbox"/> Monday Only (Bring your NCEES-approved calculator)	\$220	\$320
<input type="checkbox"/> Tuesday Only	\$470	\$570
<input type="checkbox"/> Wednesday Only	\$470	\$570

REGISTRATION

Name	PLS #
Firm	
Address	
City, State	Zip
Phone	Email

PAYMENT OPTIONS

<input type="checkbox"/> Credit Card (V/MC/Disc/AX)	<input type="checkbox"/> Check	<input type="checkbox"/> Invoice my Firm
Card #	Exp. Date	
CVV Code	Total Amount \$	

To Register, detach and mail payment to: MSPS, 722 E. Capitol Avenue, Jefferson City, MO 65101
Phone: 573-635-9446 ~ Fax: 573-635-7823 ~ Email: mmps@missourisurveyor.org
Program Information: elgin1682@gmail.com
Registration Deadline: MONDAY, JULY 29, 2024

Education for the Professional Surveyor (continued)

The Land Surveyors in Illinois embraced the bachelor's degree requirement in 1989 by legislative action. Since then, the Land Surveyor has reached parity with the other Design Professionals in respect, income, and opportunity. The current pass rate nationally for first time test takers of the NCEES FS exam is around 60%, with current Surveying students at SIUE having a 70% +/- pass rate. The goal of the new program is to increase that pass rate among the graduates taking the FS within 1 year of graduation. It is also the intent of the program administrators, to monitor the pass rate data and share with industry in future articles concerning education in the surveying profession. The Land Surveying and Geomatics graduates and successful Licensures in Land Surveying now have additional career pathways that were not available in the past. My hope is that it is clear that to become a Licensed Professional Surveyor across America, significant coursework is needed (actually required) to be prepared for the national test for licensure. The Bachelor of Science Degree in Land Surveying and Geomatics at SIUE should be considered no matter what state you live in, for preparing for the Land Surveyor's exam. The coursework prepares the student to be licensed in any state across America, based on their educational requirements, giving graduates the flexibility to seek career paths in Surveying and Geospatial Sciences across the nation, increasing the future Surveyors option of location, parity with other design professions, salary, benefits, and culture.

In a final note, education is but one step in the Professional Land Surveyor's path to licensure. The mentoring and practical experience component carries equal weight in that journey to licensure as a Professional Land Surveyor.



I truly hope that this article is read in a positive light for which it is intended. The Surveyor of the past has always had to adapt to changing technology in the tools that we were given, for measurements in the field and the final product prepared in the office. The fact that the Surveying profession today provides so many other career pathways beyond land surveying itself requires an increased focus on expanding surveying education coursework which we have developed at SIUE over the last 15 years and look forward to continuing to provide education for the Surveyor of tomorrow.

David J. Sherrill PS, is Program Director Land Surveying and Geomatics Southern Illinois University Edwardsville. 

Reprinted with permission from American Surveyor. Article published in original format at: <https://amerisurv.com/2024/03/24/education-for-the-professional-surveyor/>

**KLIETHERMES
RESEARCH, LLC**
Property & Ancestry Research
PATRICK KLIETHERMES
P.O. Box 234 • Loose Creek, MO 65054
kliethermesresearch@gmail.com
573-694-9475

Keith M. Brickey, P.L.S. Office: 573 634-6485
Fax: 573 634-8888

 **CENTRAL MISSOURI
PROFESSIONAL SERVICES, INC.**
Engineering • Surveying
Materials Testing • GIS Services

2600 E. McCarty Street
Jefferson City, MO 65101

kbrickey@cmps-inc.com
www.cmps-inc.com

In Memory of Scotty Simer, PLS – Oregon County Surveyor

Scotty Dale Simer, age 53, of Thayer, Missouri, passed away May 4, 2024, at his home. Scotty was born March 18, 1971, in West Plains, Missouri, to Alan and Jean (Crawford) Simer.

Scotty liked to go fishing, hunting, and golfing in his spare time. He loved to talk, tell stories, help others and coach football. He was a very smart, hardworking, selfless person who was proud of the life that he had built and the loved ones he surround himself with. He was a longtime member of the Clifton Masonic Lodge in Thayer, Missouri. He served as Oregon County surveyor for 23 years.

Scotty was a devout believer in God. He will be greatly missed by all that knew him.

He is survived by four children Eric, of West Plains, Missouri, Isaac, of Thayer, Missouri, Maddy, of Columbia, Missouri and Evan, of St. Louis, Missouri; one granddaughter Emilia Simer; one brother Danny Simer, wife Maggie; two nephews Sam Simer, wife Annalise, and Anthony Braim, wife Bethani; one niece Rachel Braim; a host of great nieces, nephews, cousins, and friends.

He is preceded in death by his parents; one sister Vonda Kay Simer Overbeck; and one nephew Tyler Owen Simer.

Services were held graveside followed by interment on May 11, 2024, at Thayer Cemetery in Thayer, Missouri. 🇺🇸



Be a Magazine Cover Model or News Maker!

Highlight your work! Impress your friends! Make your mamma proud! Prove to the bankers you are using that commercial loan!

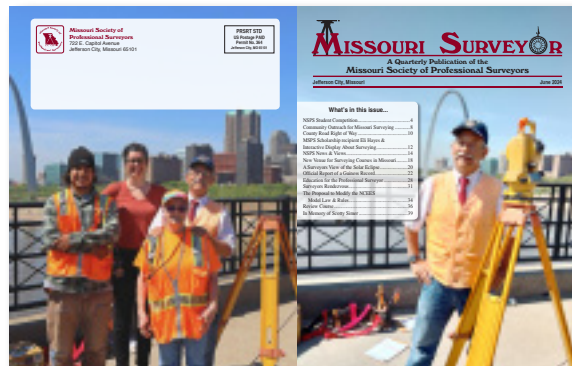

“How” you may ask? By sharing photos, stories and news with Missouri Surveyor! It is really that simple. Just as this edition’s cover features Missouri surveyors you and your work may be featured as well. All content is welcome! For the cover, high quality images in landscape format at an aspect-ratio comparable to 17”x11” work best; stories and articles merely need to be in Microsoft Word. 🇺🇸



**Missouri Society of
Professional Surveyors**

722 E. Capitol Avenue
Jefferson City, Missouri 65101

PRSR STD
US Postage PAID
Permit No. 364
Jefferson City, MO 65101

